

SUBJECT TO VACANT POSSESSION



**M** UNIT 5

M Brough  
Brough  
East Yorkshire  
HU15 1AF

Occupiers Include

 **morgan & quinn**  
carpet & flooring specialists

 **Busy Bees**

**DESCRIPTION**

Brough is an established and affluent settlement located approximately 13 miles west of Hull, just off the A63 which is the main arterial route connecting Hull with the M62 motorway and the wider region.

Brough Shopping Centre is the principal retail destination serving the catchment and is located on Welton Road, adjacent to Morrisons and The Red Hawk community public house, with occupiers including Brough Pharmacy, Sightcare Opticians, Morgan & Quinn carpets & flooring, Limb Estate Agents, Andrew Earle's Holidays and Busy Bees nursery. There is also free shopper parking (approximately 50 spaces).

The available unit is in a prominent position overlooking the car park in between Brough Pharmacy and Sightcare Opticians and is suitable for a variety of uses including retail, professional services, healthcare, etc (subject to the necessary consents).

**AREA**

938 sq.ft (87.1 sq.m)

**RENT**

£20,000 per annum plus VAT

**BUSINESS RATES**

Rateable Value: £18,250

**SERVICE CHARGE & INSURANCE**

Service Charge: Approximately £2,278 per annum plus VAT.

Insurance to be confirmed.

**ENERGY PERFORMANCE**

EPC rating C:62. Further information available upon request.

**PLANNING**

It is the incoming tenant's responsibility to verify that their intended use is acceptable to the Local Planning Authority.

**LEGAL COSTS**

Each party is responsible for their own legal costs in connection with the granting of a lease.

**VAT**

VAT at the prevailing rate is payable on all sums due to the landlord under the terms of the lease.

**7**

Retail Units On-Site

**938 sq.ft**

Unit Area

**What Three Words**

dominate.winning.distracts

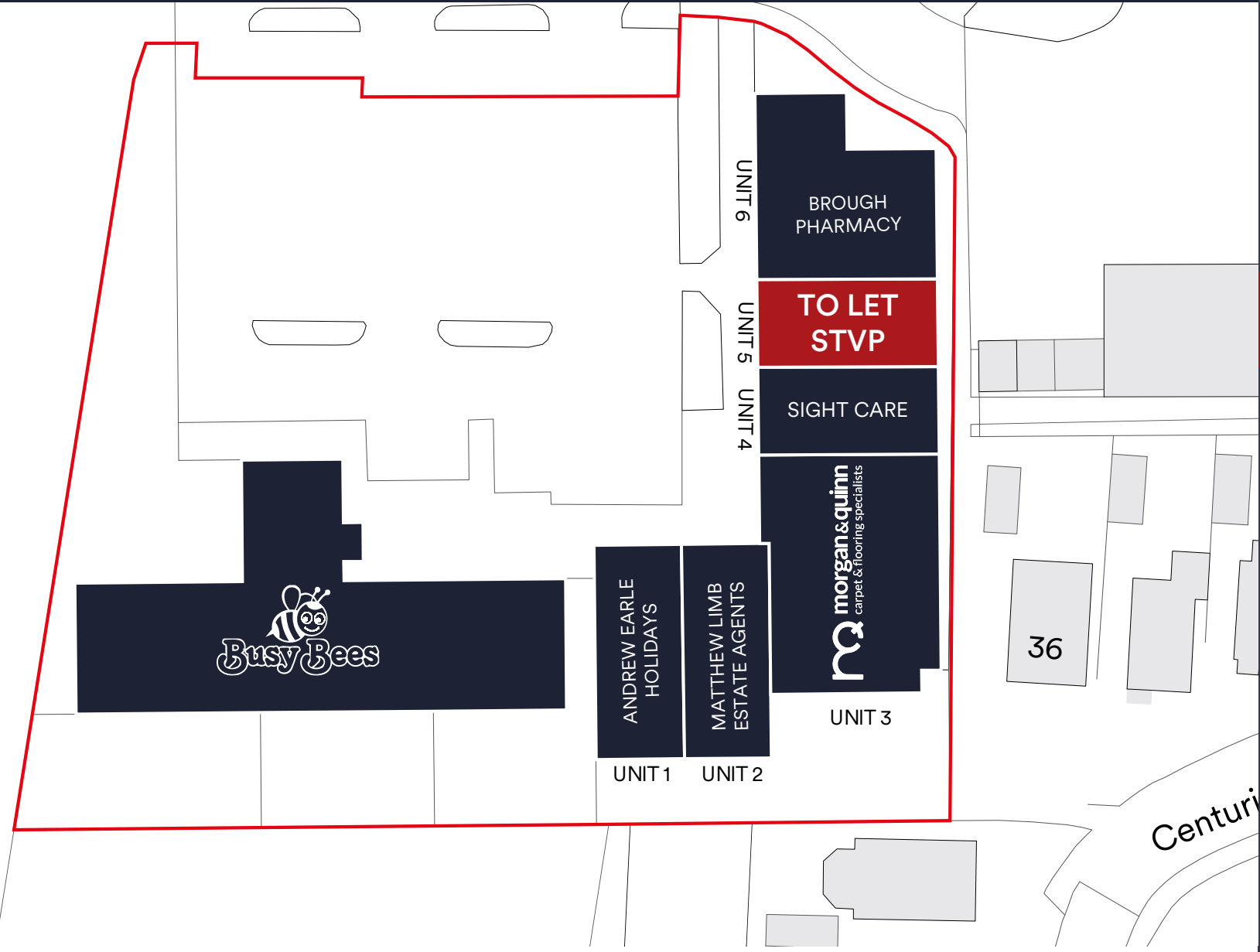

**Will Helm**  
 07774 666805  
 WHelm@lcpproperties.co.uk

**Viewing**  
 Strictly via prior appointment  
 with the appointed agents



**Richard Webster**  
 07739 680472  
 rw@newswebster.com

MISREPRESENTATION ACT 1967 London & Cambridge Properties Limited (Company Number 02895002) the registered office of which is at LCP House, Pensnett Estate, Kingswinford, West Midlands DY6 7NA its subsidiaries (as defined in section 156 of the Companies Act 2006) associated companies and employees ("we") give notice that: Whilst these particulars are believed to be correct no guarantee or warranty is given, or implied therein, nor do they form any part of a contract. We do our best to ensure all information in this brochure is accurate. If you find any inaccurate information, please let us know and where appropriate, we will correct it. We make no representation that information is accurate and up to date or complete. We accept no liability for any loss or damage caused by inaccurate information. This brochure gives a large amount of (statistical) information and there will inevitably be errors in it. Intending purchasers or tenants should not rely on the particulars in this brochure as statements or representations of fact but should satisfy themselves by inspection or otherwise as to the correctness of each of them. We provide this brochure free of charge and on the basis of no liability for the information given. In no event shall we be liable to you for any direct or indirect or consequential loss, loss of profits, revenue or goodwill arising from your use of the information contained herein. All terms implied by law are excluded to the fullest extent permitted by law. No person in our employment has any authority to make or give any representation or warranty whatsoever in relation to the property. SUBJECT TO CONTRACT. We recommend that legal advice is taken on all documentation before entering into a contract. You should be aware that the Code of Practice on Commercial Leases in England and Wales strongly recommends you seek professional advice from a qualified surveyor, solicitor or licensed conveyancer before agreeing or signing a business tenancy agreement. The Code is available through professional institutions and trade associations or through the website <https://www.rics.org/uk/upholding-professional-standards/sector-standards/real-estate/code-for-leasing-business-premises-1st-edition/>. LCP's privacy notices that apply to its use of your personal information are at [www.lcpgroup.co.uk/policies](http://www.lcpgroup.co.uk/policies). The privacy notice that applies to you will depend on the nature of your relationship with LCP, and in some cases more than one may apply to you. LCP's privacy policy giving a high level overview of how LCP approaches data protection and your personal information can be found at [www.lcpproperties.co.uk/policies/files/LCP-Privacy-Web-and-Data-Policy-May2018.pdf](http://www.lcpproperties.co.uk/policies/files/LCP-Privacy-Web-and-Data-Policy-May2018.pdf).

\*\*Average data taken from research carried out between 7th to 13th February 2018, where cars parking at the centre were counted by an automated system. Number of visitors per car averaged at 2 per vehicle. The figure does not include visitors arriving on public transport or walking to the centre.