

12.6m
Annual Footfall*

*1014 data provided by MyTraffic

2,500
FREE Car Park Spaces



THE GALLERIES
LEISURE

500k
Catchment Population

49TH*
SHOPPING CENTRE
IN THE UK

*TREVOR WOOD 'GOING SHOPPING 2025 REPORT



Occupiers Include



STARBUCKS



Hollywood Bowl

LOUNGERS



Sainsbury's

ASDA



M THE GALLERIES

More than a shopping centre, M The Galleries is the town centre. Washington is strategically positioned between the key regional cities of Newcastle, Sunderland and Durham.

Anchored by Sainsbury's and Asda, M The Galleries is home to a wide range of national and local, independent retailers alongside service providers and leisure operators.

M

THE GALLERIES
LEISURE



49TH*

SHOPPING CENTRE
IN THE UK

*TREVOR WOOD 'GOING SHOPPING 2025 REPORT

£4bn

CATCHMENT
SPENDING POWER*

*PRAGMA CATCHMENT & CONSUMER
ASSESSMENT, JULY 2022.



2,500

FREE Car Park Spaces and
a regional bus station with
over 700 arrivals daily

*GOING NORTH EAST

PLUS OVER 125

RETAIL AND SERVICE
PROVIDERS

First Floor accessibility from all car parks
and bus station.

East and West side plots have the
potential for dedicated 24-hour access.

*Subject to Planning.

FIRST FLOOR DEVELOPMENT OPPORTUNITIES



EAST SIDE DEVELOPMENT OPPORTUNITY



18,979 sq.ft
East Side Development Opportunity



THE GALLERIES
LEISURE

Proposed CGI images

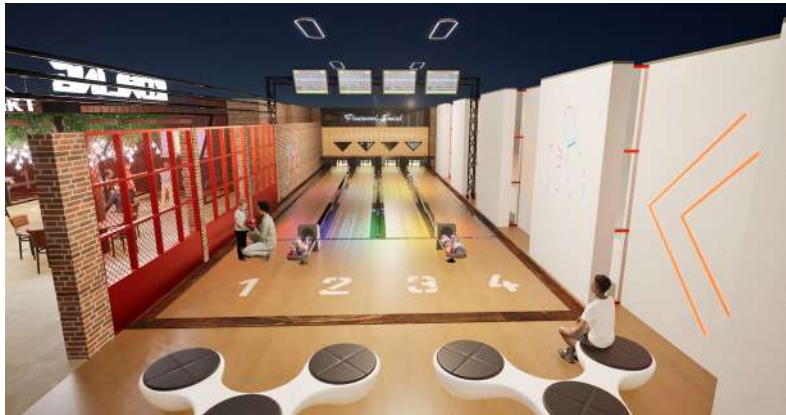

LOCATION

M The Galleries is located just off the A1231 and within easy reach of both the A1 and A19.

With great transport links and ample parking, M The Galleries is easily accessible being 7 miles west of Sunderland, 11 miles north of Durham and 10 miles south east of Newcastle upon Tyne.



SUNDERLAND
11 MIN DRIVE



NEWCASTLE
12 MIN DRIVE



DURHAM
14 MIN DRIVE

Car Parking

For those travelling by car there are over 2,500 FREE customer spaces across a number of different car parks. There are also 30 EV Charging Points on-site.

Nearest Transport links

The nearest train stations to the centre are Sunderland, Newcastle and Durham. There is also a bus station immediately adjacent to The Galleries which feeds shoppers directly into the Centre.



Simon Eatough
01384 400123
07771 764148
SEatough@lcpproperties.co.uk

Viewing
Strictly via prior appointment
with the appointed agents:



Dominic Bouvet
07970 380025
dominic.bouvet@cushwake.com

Mike Bumford
07890 943042
mike.bumford@cushwake.com



MISREPRESENTATION ACT 1967 London & Cambridge Properties Limited (Company Number 02895002) the registered office of which is at LCP House, Bennett Estate, Kingwinford, West Midlands DY6 7PA. Its subsidiaries (as defined in section 1156 of the Companies Act 2006) associated companies and employees ("we") give notice that: Whilst these particulars are believed to be correct no guarantee or warranty is given, or implied therein, nor do they form any part of a contract. [We do our best to ensure all information in this brochure is accurate. If you find any inaccurate information, please let us know and where appropriate, we will correct it.] We make no representation that information is accurate and up to date or complete. We accept no liability for any loss or damage caused by inaccurate information. This brochure gives a large amount of (statistical) information and there will inevitably be errors in it. Intending purchasers or tenants should not rely on the particulars in this brochure as statements or representations of fact but should satisfy themselves by inspection or otherwise as to the correctness of each of them. We provide this brochure free of charge and on the basis of no liability for the information given. In no event shall we be liable for any direct or indirect or consequential loss, loss of profit, revenue or goodwill arising from your use of the information contained herein. All terms implied by law are excluded to the fullest extent permitted by law. No person in our employment has any authority to make or give any representation or warranty whatsoever in relation to the property. SUBJECT TO CONTRACT. We recommend that legal advice is taken on all documentation before entering into a contract. You should be aware that the Code of Practice on Commercial Leases in England and Wales strongly recommends you seek professional advice from a qualified surveyor, solicitor or licensed conveyancer before agreeing or signing a business tenancy agreement. The Code is available through professional institutions and trade associations or through the website: <https://www.rics.org/uk/upholding-professional-standards/section-standards/real-estate/code-for-leasing-business-premises-1st-edition/>. LCP's privacy notices that apply to its use of your personal information are at www.lcpgroup.co.uk/policies. The privacy notice that applies to you will depend on the nature of your relationship with LCP, and in some cases more than one may apply to you. LCP's privacy policy giving a high level overview of how LCP approaches data protection and your personal information can be found at www.lcpproperties.co.uk/uploads/files/LCP-Privacy-Web-and-Data-Policy-May-2018.pdf.