

# TO LET

1,367 sq.ft (127 sq.m)

Subject to VP

15.4m  
footfall

## Phase 1 Unit 86, The Centre, Livingston, EH54 6HR

- Ground Floor retail unit
- Close proximity to ASDA
- Other nearby retailers include Greggs, Iceland, H Samuel, Primark and Poundland

Areas (approx. NIA)	Sq.ft	Sq.m
Ground Floor	1,367	127
<b>TOTAL</b>	<b>1,367</b>	<b>127</b>

### Description

The Centre Livingston offers 7,200 car parking spaces. With key fashion anchors including Flannels, River Island, Primark, JD, M&S, H&M and Schuh, The Centre is the natural choice for the fashion-conscious shopper. This offer is bolstered by other popular retailers such as Boots, Superdrug and F&B outlets including Five Guys, Wagamama, Nando's, Subway and Greggs. It benefits from circa 1,166,666 visitors a month.

### Location

Approximately 14 miles west of Edinburgh and 35 miles east of Glasgow. Livingston has key transport links to both cities by way of a central bus terminal, two train stations and connections to Scotland's central road network.





## Phase 1 Site Map



## Unit Floor Plan

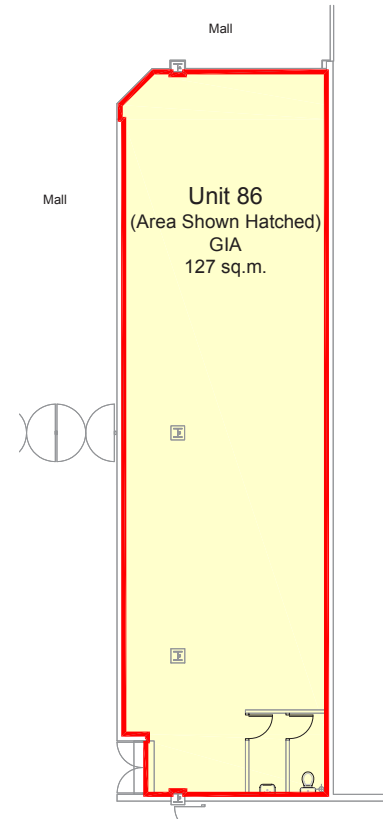

### Rent

£45,000 per annum.

### Rates

Rates Payable £20,020. Interested parties are advised to contact the local authority to confirm their liabilities and any transitional relief.

### Services

Electricity, water and drainage are connected to the property.

### Service Charge & Insurance

This unit participates in a service charge £18,548 plus VAT per annum. Insurance £880 plus VAT per annum. The Landlord will insure the premises the premiums to be recovered from the tenant.

**Viewing** Strictly via prior appointment with the appointed agents:

### Energy Performance

Further information available upon request.

### Planning

It is the incoming tenant's responsibility to verify that their intended use is acceptable to the Local Planning Authority.

### Legal Costs

Each party is responsible for their own legal costs in connection with the granting of a lease.

**savills**  
savills.co.uk/retail  
**0131 247 3800**

**Stuart Moncur** 07887 795506  
Stuart.moncur@savills.com

**Charlie Hall** 07807 999693  
Charlie.hall@savills.com

**Michelle McLaughlin** 07977 851507  
Michelle.mclaughlin@savills.com

MISREPRESENTATION ACT, 1967 London & Cambridge Properties Limited (Company Number 02895002) the registered office of which is at LCP House, Pensnett Estate, Kingswinford, West Midlands DY6 7NA its subsidiaries (as defined in section 1156 of the Companies Act 2006) associated companies and employees ("we") give notice that: Whilst these particulars are believed to be correct no guarantee or warranty is given, or implied therein, nor do they form any part of a contract. [We do our best to ensure all information in this brochure is accurate. If you find any inaccurate information, please let us know and where appropriate, we will correct it.] We make no representation that information is accurate and up to date or complete. We accept no liability for any loss or damage caused by inaccurate information. [This brochure gives a large amount of statistical information and there will inevitably be errors in it. Intending purchasers or tenants should not rely on the particulars in this brochure as statements or representations of fact but should satisfy themselves by inspection or otherwise as to the correctness of each of them. We provide this brochure free of charge and on the basis of no liability for the information given. In no event shall we be liable to you for any direct or indirect or consequential loss, loss of profit, revenue or goodwill arising from your use of the information contained herein. All terms implied by law are excluded to the fullest extent permitted by law. No person in our employment has any authority to make or give any representation or warranty whatsoever in relation to the property, SUBJECT TO CONTRACT. We recommend that legal advice is taken on all documentation before entering into a contract. You should be aware that the Code of Practice on Commercial Leases in England and Wales strongly recommends you seek professional advice from a qualified surveyor, solicitor or licensed conveyancer before agreeing or signing a business tenancy agreement. The Code is available through professional institutions and trade associations or through the website https://www.rics.org/uk/upholding-professional-standards/sector-standards/real-estate/code-for-leasing-business-premises-1st-edition/. LCP's privacy notices that apply to its use of your personal information are at www.lcpgroup.co.uk/policies. The privacy notice that applies to you will depend on the nature of your relationship with LCP, and in some cases more than one may apply to you. LCP's privacy policy giving a high level overview of how LCP approaches data protection and your personal information can be found at www.lcpproperties.co.uk/uploads/files/LCP-Privacy-Web-and-Data-Policy-May-2018.pdf.

**EYCO**  
**0131 226 2641**  
www.eyco.co.uk

**Alastair Rowe** 07747 747280  
arowe@eyco.co.uk

**Alexandra Campbell** 07425 335353  
acampbell@eyco.co.uk

**Ruari Hobkirk** 07507 689448  
rhobkirk@eyco.co.uk

Owned and Managed by

**M Core**  
LCP UK  
**01384 400123**  
lcpgroup.co.uk

**Simon Eatough** 07771 764148  
SEatough@lcpproperties.co.uk